



TI-P157-05

CMGT Issue 5

Hosedown Gun, Hose and Hose Rack

Gun

Description

The Spirax Sarco hosedown gun is designed for use on any hot or cold water wash down and cleaning hose application. When the trigger is released water flow ceases which can save up to 60% of your hosed water cost.

Sizes

1/2" gun with 8" internals for use with 1/2" hosedown station
3/4" gun with 9" internals for use with 3/4" hosedown station

Connections

The hosedown guns have a 1/2" NPT female connection, which accepts the swivel coupling that is pre-fitted to the hose.

Limiting conditions

Body design conditions	PN25
Maximum design temperature	100 °C
Maximum working pressure	10 bar g
Maximum operating temperature	100 °C

How to order

Example: 1 off Spirax Sarco 1/2" hosedown gun.

Hose

Description

The Spirax Sarco hose is suitable for conveying steam, hot and cold water. It is a dairy washdown steam hose rated to 170 °C for steam conditions.

Sizes

1/2" x 20 m dairy quality hose complete with crimped on 1/2" swivel coupling
3/4" x 20 m dairy quality hose complete with crimped on 3/4" swivel coupling

Connections

Hose coupling have a 1/2" NPT male taper thread to connect into gun. See Installation and Maintenance Instructions IM-P157-03 for connection procedure.

Limiting conditions

Maximum working pressure	7 bar g
Maximum working temperature for hot water	95 °C

How to order

Example:

1 off Spirax Sarco 1/2" x 20 m dairy quality hose complete with crimped swivel coupling and hose protectors.

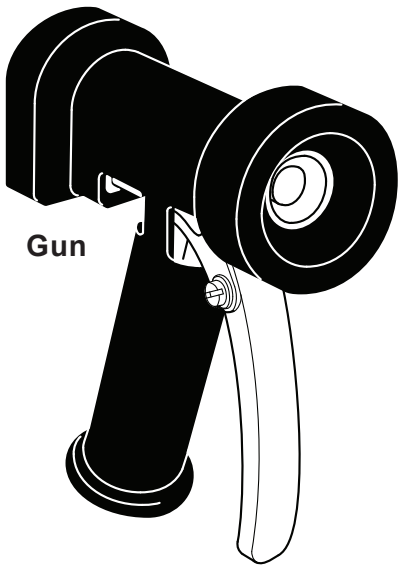

Gun

Rack and hose

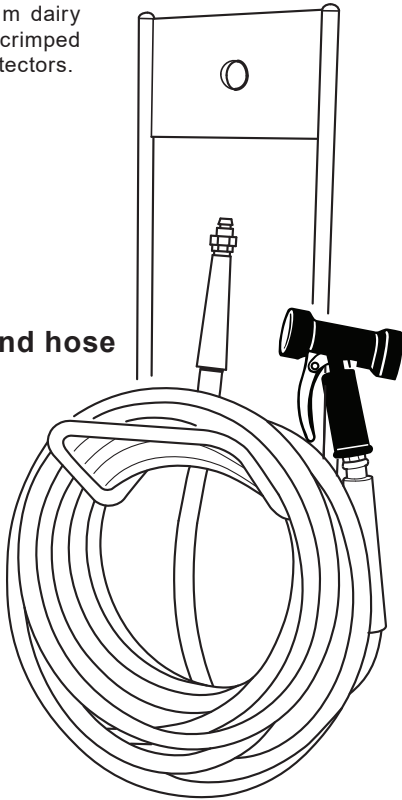

Pipeline ancillaries
Hosedown stations

Materials

No.	Part	Material
1	Insulated covers	Rubber Perbunan
2	Body	Brass Ms58
3	Piston	Stainless steel Niro Wnr.4305
4	Lever handle	Nylon coated brass Ms58
5	Spring	Stainless steel Niro Wnr.4305
6	Linkage	Brass Ms58
7	Piston seal	Rubber EPDM 90 Schore
8	Gasket	Klingerit It 200
9	'O' ring	Rubber Perbunan
10	Hose	Reinforced EPDM
11	Hose protector	Rubber PVC/Nitrile
12	Hose rack	Stainless steel

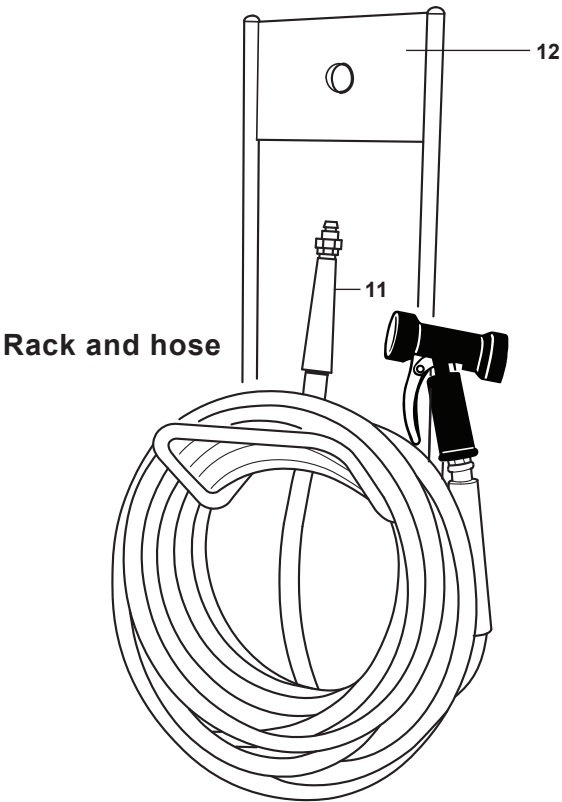
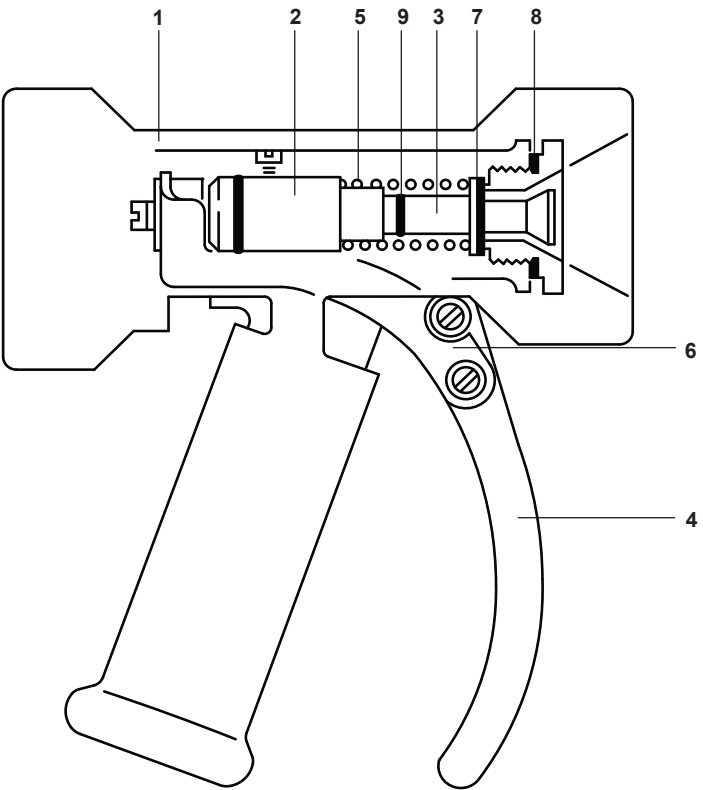
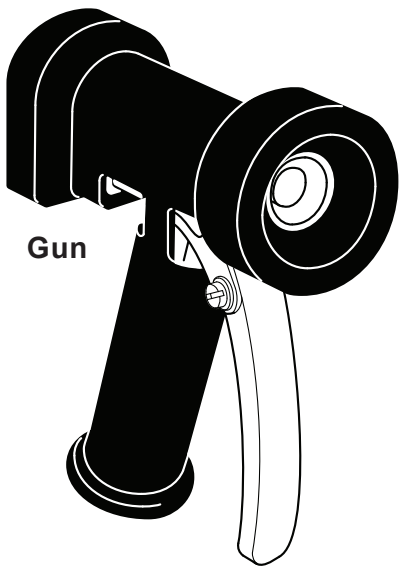

Gun

Dimensions/weights (approximate) in mm and kg			
A	B	C	Weight
140	200	55	0.9

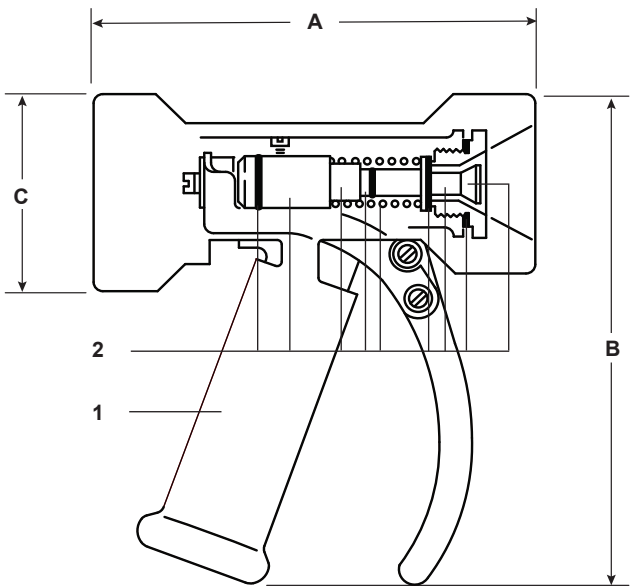

Spares

Cover kit	Cover for gun body	1
Internal parts set	Needle valve, orifice nozzle, spring	2
Hose coupling 1/2" and 3/4"		

Operation:

1.

If a wide spray pattern is required, squeeze the trigger a small amount.
2.

If a solid jet is required, squeeze the trigger fully.
3.

Releasing the trigger will shut off the water flow.

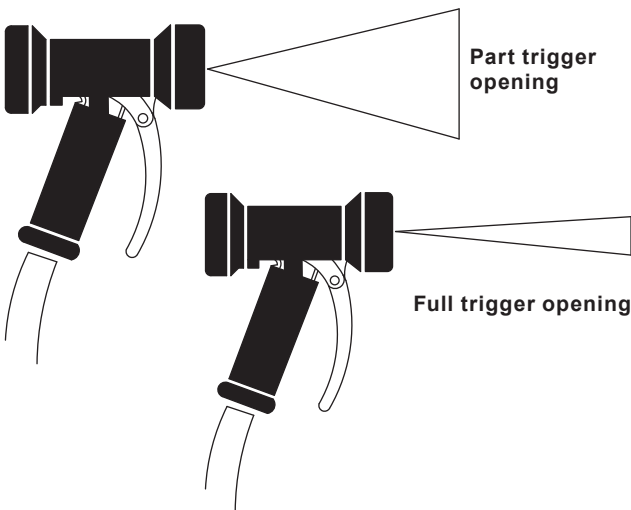

Rack

Dimensions/weights (approximate) in mm and kg				
Size	A	B	C	D
1/2", 3/4"	272	648	102	272

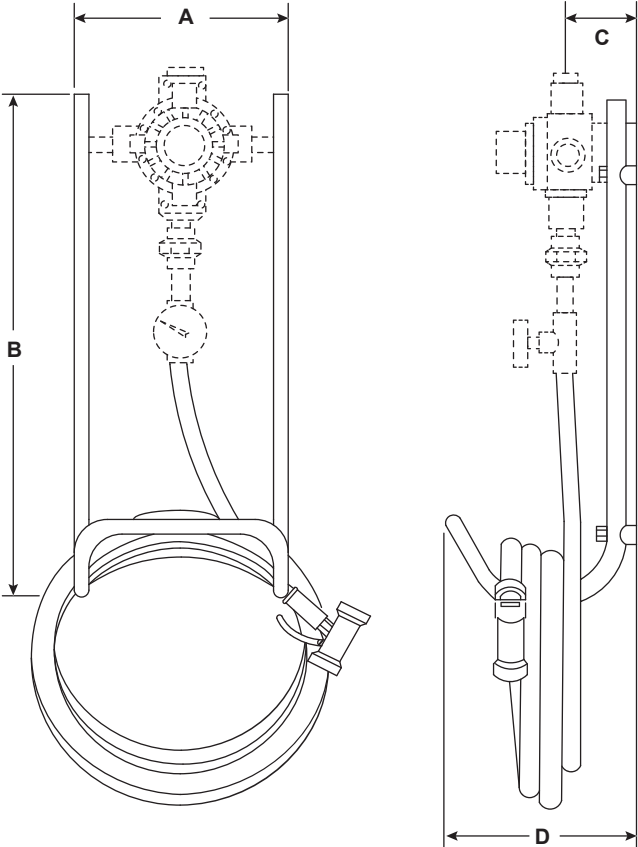

Capacity 3/4" hosedown station

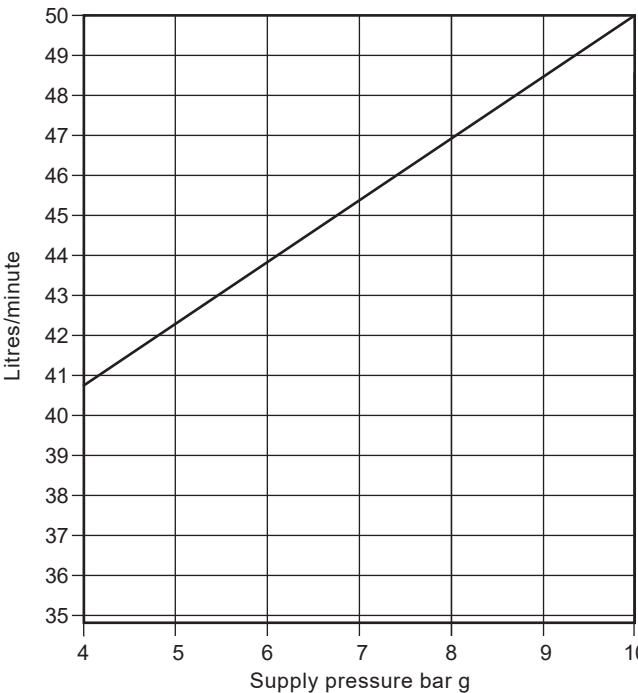



TI-P157-22

CMGT Issue 3

Type 8200L and 9300L

Self-Retracting Hose Reels

Description

The Type 8200L is a compact self-retracting hose reel for use with the MX15 Mixatherm steam/water mixing valve for hosedown applications and the 9300L is for use with the MX20. The reels have a durable powder coat finish and incorporate an internal flow path that provides minimum spring retraction resistance. The 8200L is fitted with ½" x 20 m of dairy washdown steam hose with crimped on ½" swivel coupling, hose protectors and bumper stop. The 9300L is fitted with ¾" x 20 m of dairy hose and ¾" swivel coupling.

Operation

Withdraw hose from reel under tension by firmly holding gun and hose. The hose rewinds automatically. It is important that the hose is walked back to the reel safely to avoid damage to plant and personnel.

Limiting conditions

Maximum operating pressure	7 bar g
Maximum operating temperature	95 °C

Available types

Type 8200L with ½" x 20 m of hose	Note: If manual, pneumatic, electronic or stainless steel options are required, please contact Spirax Sarco.
Type 9300L with ¾" x 20 m of hose	

Materials

No.	Part	Material
1	Base and upright assembly	Carbon steel
2	Reel assembly	Carbon steel
3	Guide arm	Carbon steel
4*	Swivel assembly	Carbon steel
5	Ratchet, flow casting	Aluminium
6	Hose	Reinforced EPDM
7	Hose protector	Rubber PVC/Nitrile
8	Coupling	Brass chrome plated
9	Hose bumper assembly	Rubber

* Items 4 is shown overleaf

Certification

No certification is available for this product.

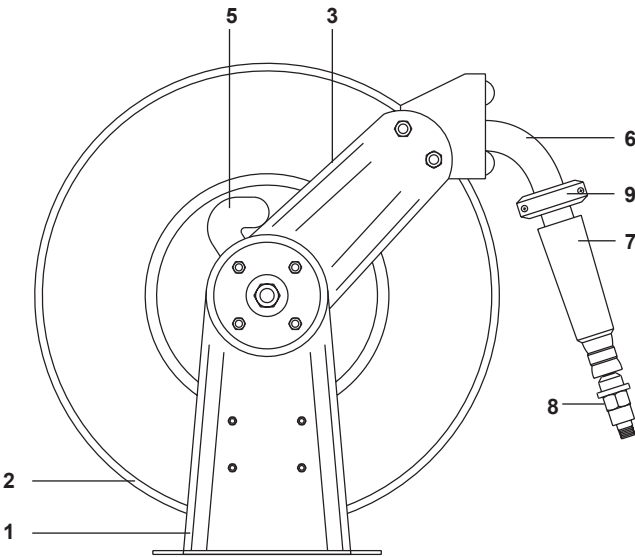

Pipeline ancillaries
Hosedown stations

Dimensions (approximate) in mm

Type	A	B	C	D	E	F
8200L	610	645	211	267	254	153
9300L	622	645	289	362	267	199

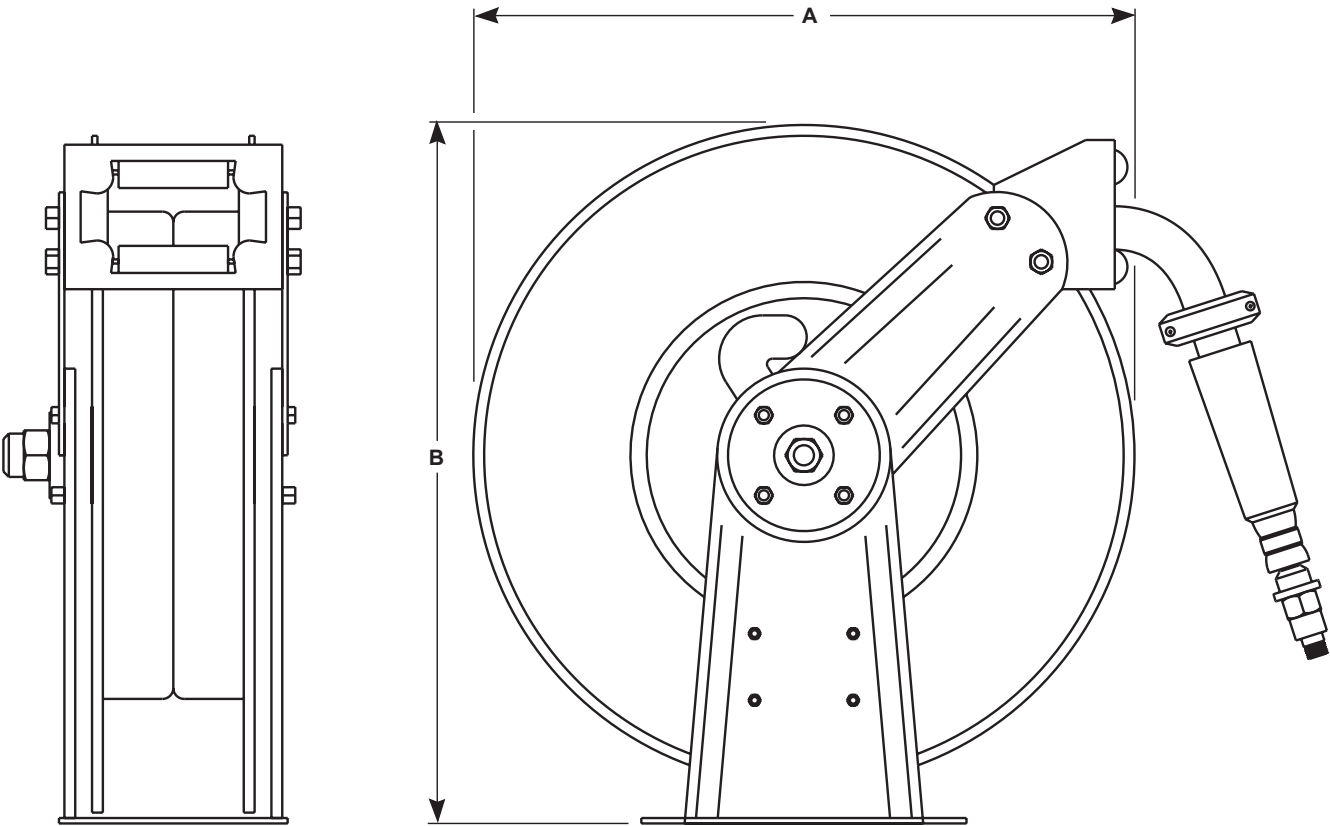
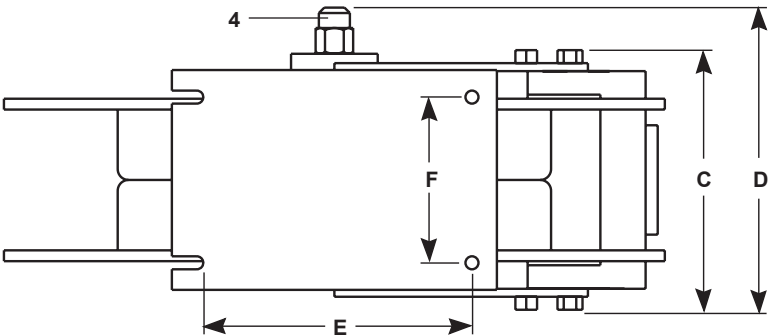

Installation

The adjustable guide arm allows for floor, wall or ceiling mounting. A flexible hose connection must be used between the hose reel and the mixing valve station to prevent possible misalignment and binding. The maximum installation height between the mixing valve station and reel is 4.8 m. This must not be exceeded. However, Spirax Sarco supply a 2 m length of hose with the reel for this purpose.

Maintenance

For more detailed installation and maintenance instructions please refer to the separate Installation and Maintenance sheet which is supplied with the product.

How to order

Spirax Sarco Type 8200L self-retracting hose reel with ½" x 20 m dairy quality hose complete with crimped swivel coupling and hose protectors.

Spare parts

Please consult Spirax Sarco for separate literature supplied with the product regarding spare parts and servicing.